

# SolarPIR™ User's Manual

Indoor Motion Detection Alarm with Solar Panel

## © Copyright 2011

This manual is furnished under license and may be used or copied only in accordance with the terms of such license. Except as permitted by such license, no part of this publication may be reproduced, stored in a retrieval system, or transmitted, in any form or any means, electronic, mechanical, recording, or otherwise, including translation to another language or format, without the prior written permission of SecurityMan. The content of this manual is furnished for informational use only, is subject to change without notice, and should not be construed as a commitment by SecurityMan. SecurityMan Inc assumes no responsibility or liability for any errors or inaccuracies that may appear in this book.

## FCC Information

This device complies with part 15 of the FCC Rules. Operation is subject to the following two conditions:

- (1) This device should not cause harmful interference.
- (2) This device must accept any interference received, including interference that may cause undesired operation. Operation of this equipment in a residential area is likely to cause interference in which case, the user at his or her own risk and expense will be required to correct the interference.

## Warranty

SecurityMan Inc warrants that this product will be free from defects in title, materials and manufacturing workmanship for a period of one year or otherwise specified on the product packaging. This limited warranty shall commence from the date of purchase. SecurityMan products warranty is not transferable and is limited to the original purchaser. If the product is found to be defective then, as your sole remedy and as the manufacturer's only obligation, SecurityMan will repair or replace the product. This warranty shall not apply to products that have been subjected to abuse, misuse, abnormal electrical or environmental conditions, normal wear and tear, or any condition other than what can be considered normal use.

### **Warranty Disclaimers**

SecurityMan Inc, makes no other warranties, express, implied or otherwise, regarding this product, and specifically disclaims any warranty for merchantability or fitness for a particular purpose. The exclusion of implied warranties is not permitted in some states and the exclusions specified herein may not apply to you. This warranty provides you with specific legal rights. There may be other rights that you have which vary from state to state.

### **Limitation of Liability**

The liability of SecurityMan Inc, arising from this warranty and sale shall be limited to a refund of the purchase price. In no event shall SecurityMan be liable for costs of procurement of substitute products or services, or for any lost profits, or for any consequential, incidental, direct or indirect damages, however caused and on any theory of liability, arising from this warranty and sale. These limitations shall apply not withstanding any failure of essential purpose of any limited remedy.

**For Tech Support Call: 888-977-3777**

### **SecurityMan**

4601 E. Airport Drive  
Ontario, CA, 91761, USA  
Tel: 888-977-3777  
Fax: 909-230-6889  
Email: [info@securitymaninc.com](mailto:info@securitymaninc.com)  
Website: [www.securitymaninc.com](http://www.securitymaninc.com)

Copyright 2011 by SecurityMan v10.1

## Table of Contents

<b>Introduction</b>	4
<b>Important Restrictions</b>	4
<b>Conditions</b>	5
<b>Package Contents</b>	6
<b>Specifications</b>	7
<b>Features</b>	7
<b>Product Basics</b>	8
<b>Setup and Operation</b>	9
Installing Batteries	9
Security Code	10
Mounting SolarPIR™	10
<b>Operation</b>	12
<b>Troubleshooting</b>	13

## Introduction

Thank you for going green with the SecurityMan **SolarPIR™**. This motion detection driven alarm can be used to help protect your home and business with the comfort of its energy saving solar panel design and AA battery backup (x3 not included). The technology used in these solar panels is used to recycle indoor lighting (100+ Lux) as a source of power to help conserve and extend the battery life of the AA batteries to up to three years.

## Important

This guide provides important information on the use and operation of your **SolarPIR™**. Please read all the information carefully prior to using the product for the best performance and to prevent any damage/ injuries or misuse of the device(s). Customers are entitled to have read through this complete user's manual before using the **SolarPIR™**. Any unapproved changes or modifications will void your warranty. Please ensure to have a complete understanding of the following restrictions.

## Restrictions

When using this product, the safety precautions below must be taken to avoid possible legal liabilities and damages. Retain and follow all product safety and operating instructions. Observe all warnings in the product operating instructions. To reduce the risk of bodily injury, electric shock, fire, and damage to the equipment, observes the following precautions.

- **DO NOT** use this product to carry out any illegal activities. SecurityMan shall not be responsible for any consequences of illegal conducts made by users.

- **DO NOT** put the plastic package bags in reach of children or babies. Young children can choke on these items if they put them into their mouths.
- **DO NOT** use rechargeable batteries. This device is not intended to be recharged.
- **DO NOT** use it aboard; please abide by the airway's provision. It might influence communication aboard and the flying apparatus if departing from the airway's regulation. This will result in accident, possible death and severe physical hurt.
- **DO NOT** disassemble or attempt to repair the PIR yourself. Improper disassembly might cause damages to the product or the peripheral equipment.
- **DO NOT** use chemicals to clean the sensor, as they may cause damage to the plastic and cause alarm to malfunction.

## Conditions

Please read the following messages to make sure your working environment is suitable.

- The temperature should be kept between  $-10^{\circ}\text{C}$  and  $50^{\circ}\text{C}$  ( $14^{\circ}\text{F}$  to  $122^{\circ}\text{F}$ ). The relative humidity should be kept between 20% and 80%.
- Avoid putting the product in places where temperature or humidity may change rapidly.
- Keep product away from heat sources such as electric heaters.
- Do not use the PIR near harmful chemicals.
- Do not place product near any strong magnetic objects

- It might influence the normal operation of the product if used at the fringe range of normal temperature. Please turn off the power when not in use.
- Do not disassemble the product.
- Do not shake or strike the product.
- Please obey the local government's environment protection policy.

## Package Contents



**SolarPIR™**



**Screws**



**User's Manual**

## Specifications

<b>PIR Range</b>	8m/26ft
<b>Detecting Angle</b>	40° horizontal, 75° vertical
<b>Operating power</b>	3 x AA (1.5v) Alkaline Batteries
<b>Power Consumption</b>	20uA
<b>Solar Lighting</b>	100 Lux (minimum)
<b>Alarm Sound</b>	130dB
<b>Maximum Alarm Time</b>	30 Seconds
<b>Pet Immunity</b>	11 lbs.
<b>Security</b>	4 digit programmable code
<b>Dimensions</b>	70mm x 116mm x 33mm (WxHxD)

## Features

- PIR motion detection coverage: up to 8m (26 ft)/40 degree horizontal; 6m (20ft)/75 degree horizontal
- Pet immunity weight: 5 Kg (11 lbs) to reduce false alarm
- Energy efficient with solar panel and backup batteries (3xAA, not included)
- Ultra alarm sound 130dB for average home coverage
- Delay time to exit is 30 seconds and 5 seconds entry delay
- Programmable 4 digits security code via front four keys
- Battery low light indicator
- Low power consumption design with stand by current 20  $\mu$ A
- Minimum lighting level for solar panel: 100 Lux
- Dimensions: 70 (W) x 116 (H) x 33mm (D) (2.75" x 45.67" x 1.30")



## Product Basics

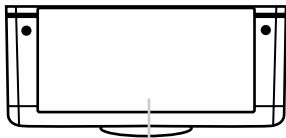

Solar Panel

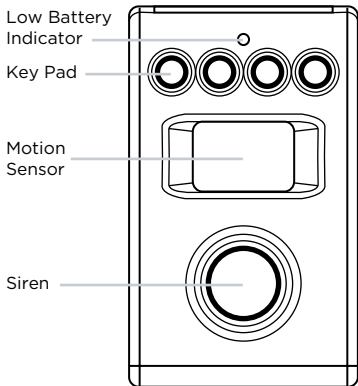

Low Battery Indicator

Key Pad

Motion Sensor

Siren

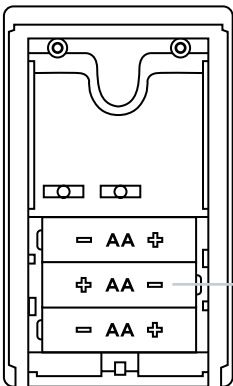

Battery Compartment

## Setup and Operation

### Installing Batteries

Use a Philip screw driver to remove the back panel to get to the battery compartment as shown below. Insert 3 x AA size batteries (not included) into the battery compartment; make sure the polarities are correct when installing the batteries. Don't put the rear panel back on yet until SolarPIR is ready to mount as illustrated in the next two sections below.

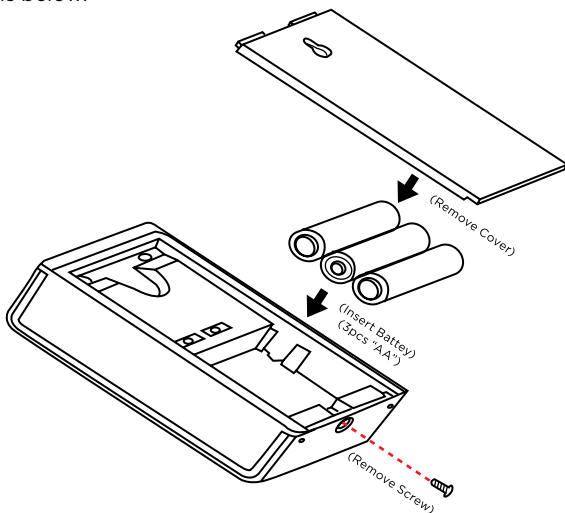

## Security Code

The SolarPIR comes with a security code that can be use to arm the alarm motion sensor when away from home and disarm the alarm motion sensor when entering. The manufacturer default security code for the alarm motion sensor is 1234.

To change the 4 digit Security Code please do the following:

- Input the factory default security code “1234” (the red LED will start to flash for 30 seconds indicating that the unit is in programming mode).
- Enter the new 4 digit security code (the red LED will stop flashing when the new security code is successfully changed and the alarm is back to disarm mode).

**NOTE:** The first digit of the new security pass code cannot be the number 4. Please remember your new password and jot it down.

## Mounting SolarPIR™

1. Find and place the alarm in the desired location, preferably facing the front door or any open area recommended about 5 1/2 - 6 feet from the ground.
2. Remove and mount the back cover bracket to a desired location as shown below. Secure the mounting bracket with the two screws provided.



3. Hold the SolarPIR to hover over the mounting bracket and then slide it downward to lock the SolarPIR to the mounted bracket.



4. Secure the SolarPIR to the mounting bracket by using the screw provided to the base of the alarm siren as illustrated below.



**Note:** The SolarPIR can also be use as a free standing device on table top, on book self, on counter top and etc

## Operation

### **Arming the PIR**

To arm the SolarPIR, simply press the number 4 on the keypad. At this time you will hear a confirmation tone which indicates that the PIR has been successfully armed.

### **30-Second exit delay**

Once armed, you have 30 seconds to vacate the protected area before the PIR becomes active. Any motion detected after exit delay time has expired will trigger the alarm.

### **5-Second entry delay**

When entering the protected area, the user is given 5 seconds after being detected to disarm the SolarPIR before the siren sounds off.

### **Disarming the SolarPIR**

To disarm the SolarPIR, simply enter in the 4 digit security code. You will hear a confirmation tone which indicates that the PIR has been successfully disarmed. Please note that alarm will begin to go off if the user does not enter the 4 digit security code within the 5 seconds entry delay time frame.

### **Alarm sound**

The alarm will sound continuously for 30 seconds, then auto reset itself & continue this process if motion is detected again.

### **Low battery indicator**

The red “Low Battery” LED located at the top center of the unit will light up whenever the batteries are running low and need to be replaced.

**IMPORTANT NOTICE:** The 4 digit security code will be defaulted back to the preset factory code 1234 every time the batteries are replaced.

## Troubleshooting

**Q1: The unit does not beep when the last battery is installed?**

Make sure that you are using new batteries and that they are installed properly.

**Q2: The red light on the alarm unit is ON.**

This is an indication that the batteries are running low. Please replace all batteries with new ones.

**Q3: Will my security code stay the same when I replace the batteries?**

No, The 4 digit security code will be defaulted back to the preset factory code (1234) every time the batteries are replaced.

**Q4. Will my SolarPIR work if I don't have batteries installed in them?**

No, batteries are required to be installed for the SolarPIR to function normally.

[www.securitymaninc.com](http://www.securitymaninc.com)